

Surgical Protocol / Drilling Sequence

Eztetic® Implants

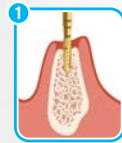

3.1 mmD



1
0201DSN
2.1/1.6 mmD,
8 mmL - 11.5 mmL
Drill

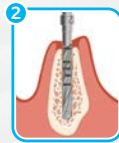

2
SV2.3DN
2.3 mmD
Drill



3
FOR SOFT BONE
SV2.4DN
2.4 mmD
Drill

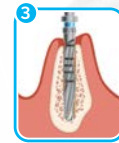

3
FOR DENSE BONE
ZOP28DN
2.8/2.4 mmD
Drill

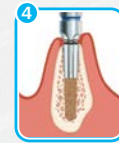

4
OPTIONAL FOR
DENSE BONE
ZOPTT30
3.0 mmD
Cortical Bone Tap

Trabecular Metal™ and TSV® Implants

3.7 mmD Implant (3.5 mmD Platform)



3.7 mmD



1
SV2.3DN
2.3 mmD
Drill

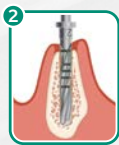

2
FOR SOFT BONE
SV2.8DN
2.8 mmD
Drill

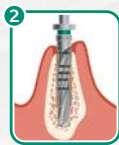

2
FOR DENSE BONE
TSV3DN
3.4/2.8 mmD
Drill

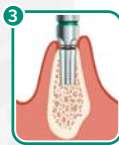

3
OPTIONAL FOR
DENSE BONE
TT3.7
3.7 mmD
Cortical Bone Tap

ATTENTION:
Bone Tap for placement in dense bone. 22 mmL Drills shown.
16 mmL Drills have depth markings for placement of 8 and
10 mm implant lengths.

4.1 mmD Implant (3.5 mmD Platform)



4.1 mmD

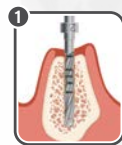

1
SV2.3DN
2.3 mmD
Drill



2
SV2.8DN
2.8 mmD
Drill



3
FOR SOFT BONE
SV3.4DN
3.4 mmD
Drill



3
FOR DENSE BONE*
TSV3.8DN
3.8/3.4 mmD
Drill

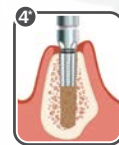

4
OPTIONAL FOR
DENSE BONE
TT4.1
4.1 mmD
Cortical Bone Tap

* When placing the 4.1 mmD Trabecular Metal Dental Implant in dense bone (Type D1), add an additional step utilizing the SV3.8DN/SV3.8DN drill after TSV3.8DN/TSV3.8DN.

4.7 mmD Implant (4.5 mmD Platform)



4.7 mmD



1
SV2.3DN
2.3 mmD
Drill



2
TSV3DN
3.4/2.8 mmD
Drill



3
FOR SOFT BONE
SV3.8DN
3.8 mmD
Drill



3
FOR DENSE BONE
TSV4DN
4.4/3.8 mmD
Drill



4
OPTIONAL FOR
DENSE BONE
TT4.7
4.7 mmD
Cortical Bone Tap

6.0 mmD Implant (5.7 mmD Platform)



6.0 mmD



1
SV2.3DN
2.3 mmD
Drill



2
TSV3DN
3.4/2.8 mmD
Drill



3
TSV4DN
4.4/3.8 mmD
Drill



4
FOR SOFT BONE
SV5.1DN
5.1 mmD
Drill



4
FOR DENSE BONE**
TSV6DN
5.7/5.1 mmD
Drill

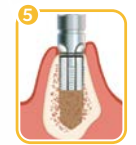

5
OPTIONAL FOR
DENSE BONE
TT6.0
6.0 mmD
Cortical Bone Tap

For complete instructions, please refer to the Surgical Manuals and Instructions for Use for the individual products.

**In dense bone, an optional additional step drill may be used before TSV6DN/TSV6DN: TSV5.1DN/TSV5.1DN. Note this additional drill is sold separately and is not included in kits.

Unless otherwise indicated, as referenced herein, all trademarks are the property of Zimmer Biomet, and all products are manufactured by one or more of the dental subsidiaries of Zimmer Biomet Holdings, Inc. and marketed and distributed by Zimmer Biomet Dental and its authorized marketing partners. For additional product information, please refer to the individual product labeling or instructions for use. Product clearance and availability may be limited to certain countries/regions. This material may not be copied or reprinted without the express written consent of Zimmer Biomet Dental. ZBINST0072 REV A 02/21 ©2021 Zimmer Biomet. All rights reserved.

